









<b>C.I.P.</b>	<b>22 Win. Mag. R.F.</b>	<b>TAB.</b>	<b>V</b>
		<b>Datum</b>	<b>84-06-14</b>
		<b>Revision</b>	<b>08-09-23</b>

Ursprungsland: US

Alternative Namen: 22 Win.Mag.,22 WMR, 22 Magnum

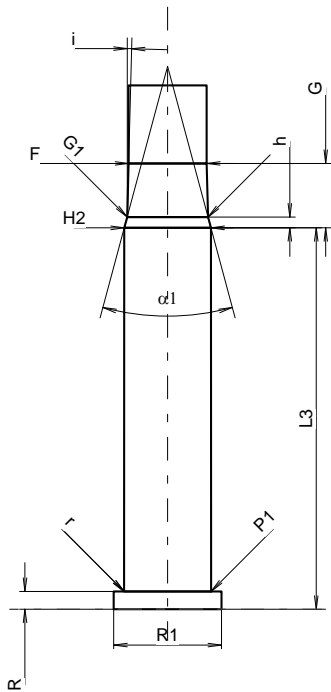
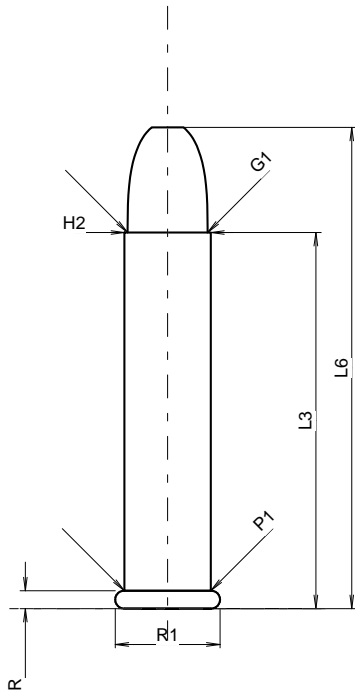

Maßstab 1.86:1

Maße in << mm >>  
 Maße und Toleranzen für Messläufe  
 siehe Anhang CR 2.

**PATRONE MAXI**

<b>Längen</b>			
L1	=		
L2	=		
L3 <sup>1)</sup>	=	26.80	
L4	=		
L5	=		
L6	=	34.29	
<b>Hülsenboden</b>			
R <sup>1)</sup>	=	1.27	-0.18
R1	=	7.47	
R3	=		
E	=		
E1	=		
e min	=		
δ	=		
f	=		
β	=		
<b>Pulverkammer</b>			
P1	=	6.15	
P2	=		
<b>Schulterkonus</b>			
α	=		
S	=		
r1 min	=		
r2	=		
<b>Hülsenhals</b>			
H1	=		
H2 <sup>1)</sup>	=	6.15	
<b>Geschoss</b>			
G1 <sup>1)</sup>	=	5.70	
G2	=		
F	=		
L3+G <sup>1)</sup>	=	31.39	
<b>Drücke (Energien)</b>			
<b>Mech. elektr. Wandler</b>			
Pmax	=	1600 bar	
PK	=	1840 bar	
PE	=	2080 bar	
M	=	17.50	
<b>Verschiedene Daten</b>			
Fe <sup>1)4)</sup>	=	0.20	
delta L	=		

**PATRONENLAGER MINI**

<b>Längen</b>			
L1	=		
L2	=		
L3 <sup>1)</sup>	=	27.18	
<b>Stoßboden</b>			
R <sup>1)</sup>	=	1.27	
R1	=	7.67	
R2	=		
R3	=		
r	=	0.25	
<b>Pulverkammer</b>			
E	=		
P1 <sup>1)</sup>	=	6.20	
P2	=		
<b>Schulterkonus</b>			
α	=		
S	=		
r1 max	=		
r2	=		
<b>Hülsenhals</b>			
H1	=		
H2 <sup>1)</sup>	=	6.17	
<b>Geschossübergang</b>			
G1 *	=	5.76	
G	=	4.59	
α1 *	=	30°	
h	=	0.77	
s	=		
i *	=	1°30'	
w	=		
<b>Lauf</b>			
F <sup>1)</sup> *	=	5.56	
Z <sup>1)</sup>	=	5.69	
<b>Züge</b>			
b	=	1.88	
N	=	6	
u	=	406.00	
Q	=	25.03	mm <sup>2</sup>

Bemerkungen: 1) Kontrolle aus Sicherheitsgründen  
 4) Verschlussabstand an Rand  
 \* Grundmaße